

## 450 Series Sanitary In-Line Sight Glass

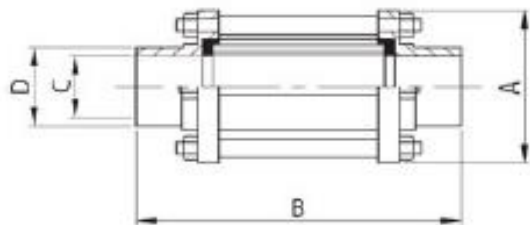

- High strength stainless steel construction.
- Pyrex Glass. Plexiglas external guard on request.
- Equipped with special tie rods and profiled seals to prevent load pressures and vibrations on the glass.
- Sanitary surface finish.
- Maximum operating pressure: 10 bar.
- Standard connections options: Butt Weld, Male RJT, Tri-clamp. Other connections available on request.



Size (mm)	A	B	C	D	Weight (Gr)
25	55.0	147.0	22.4	25.4	400
38	70.0	153.0	35.1	38.1	620
51	85.0	153.0	47.8	50.8	860
63	95.0	163.0	60.5	63.5	950
76	105.0	173.0	72.9	76.2	1100
101	140.0	173.0	97.6	101.6	2760

# PRESSURE AND TEMPERATURE RAINGS

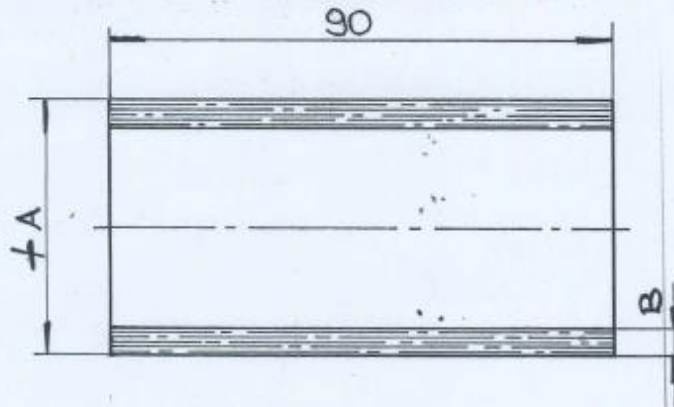

DIN	25	32	40	50	65	80	100
A	32	40	45	60	75	90	115
B	3	3,2	5	5	5	5	6
Press. es.	8 bar	8 bar	14 bar	10 bar	8 bar	6 bar	6 bar

NW	25	38	51	63	76	101
A	30	45	60	70	80	115
B	4,5	5	5	5	5	6
Press. Es.	16 bar	14 bar	10 bar	9 bar	7 bar	6 bar

TEMP. MAX. ESERCIZIO 250°C

POS. QUAN.	DENOMINAZIONE	MATERIALE	TRATTAMENTO	PESO	NOTE
QUESTO DISEGNO E' NOSTRA PROPRIETA' E NON PUO' ESSERE COPIATO, RIPRODOTTO, MOSTRATO A TERZI SENZA N.S. APPROVAZIONE SCRITTA					
S.p.A. F. III <b>TASSALINI</b>		DIS. RF	APPR.	SCALE	DATA 16-11-04
TABELLA DIMENSIONI E PRESSIONI VETRI X SPECOLE DI LINEA				ART. 450.L....	DIS. N°