



CEG is an Australasian leader of electric motors and water pumps for the industrial and domestic market.

EDX SERIES

The EDX catalogue details the complete range and specifications of this series.

The EDX Series Stainless steel centrifugal pump range covers from 0.25kW right through to 1.85kW. They are available in models EDX 70/03 to EDX 200/25.

The EDX Series centrifugal pumps are available in single and three phase and suitable for both domestic and industrial applications. All components of the pump in contact with pumped liquid are made of stainless steel AISI 304.



APPLICATION

- CIP washing (Cleaning In Place)
- Water supply and circulation for domestic use
- Sprinkler systems
- Composition of surge tank units for pressure boosting
- Bottling of pure or drinking water
- Air-conditioning or cooling system industrial washing and other special application
- Treatment and irrigation
- General water pumping including moderately aggressive liquids

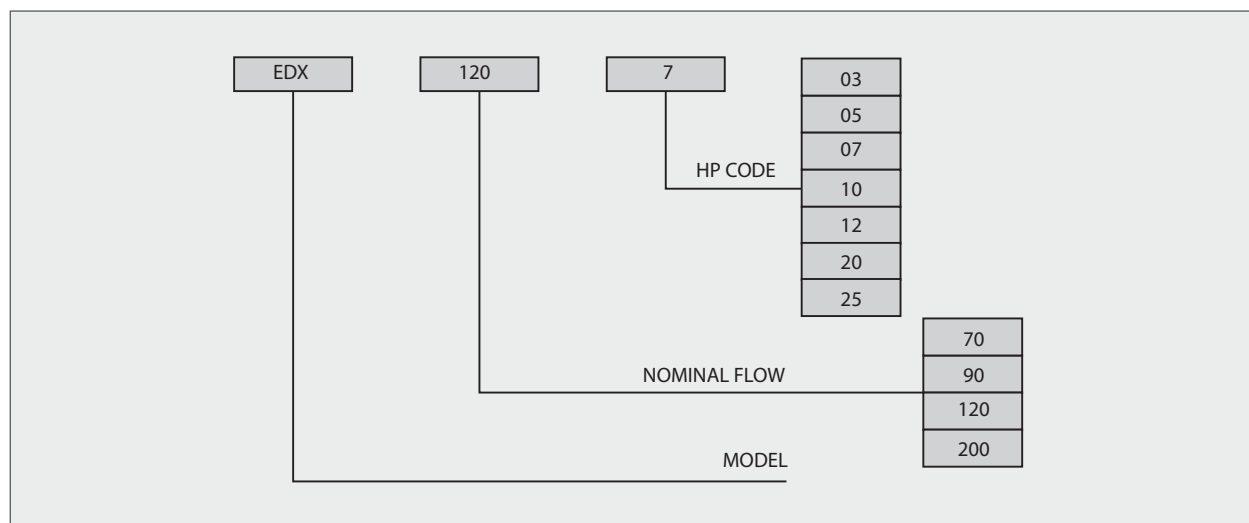



PUMP		
LIQUID HANDLED	TYPE OF LIQUID	Clean water and moderately aggressive liquids
	MAX TEMP	110°C
	MIN TEMP	-10°C
MAX WORKING PRESSURE		8 bar (116 psi)
CONSTRUCTION	IMPELLER	Closed centrifugal type
	SHAFT SEAL	Mechanical Seal (Viton)
	BEARING	Sealed ball bearing
PIPE CONNECTION	SUCTION (DNA)	EDX 70, EDX 120 G 1 ¼" (32mm) / EDX 200 G 1½" (40mm)
	DISCHARGE (DNM)	G 1" (25mm)
MATERIAL	CASING AND CASING COVER	AISI 304
	IMPELLER	AISI 304
	SHAFT SEAL	Ceramic/Carbon/Viton
	SHAFT	AISI 304
	BRACKET	Aluminium

MOTOR		
TYPE	Electric - TEFC	
	Single Phase	Three Phase
NO. OF POLES	2	
ROTATION SPEED	2800 min ⁻¹	
INSULATION CLASS	F	
PROTECTION DEGREE	IP55	
POWER RATING	kW	0.25 ÷ 1.85
	HP	0.3 ÷ 2.5
FREQUENCY	50Hz	
VOLTAGE	230V ± 10%	230/400V ± 10%
CAPACITOR	Built in	-
OVER LOAD PROTECTION	Built in	Provided by the user
CASING MATERIAL	Aluminium	
BASE MATERIAL/ MOTOR SUPPORT	Aluminium	

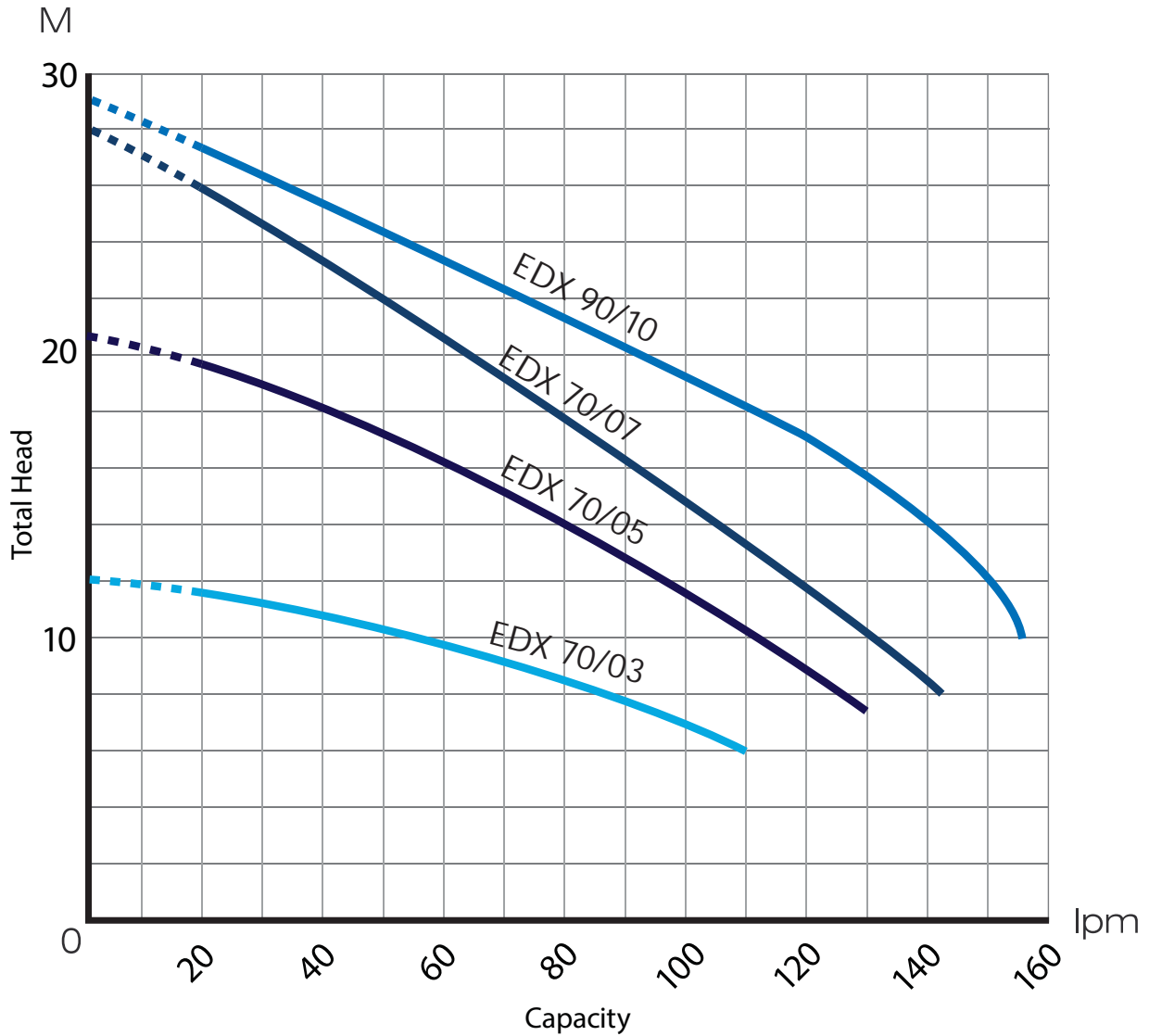

MODEL	POWER		CURRENT (A)				MAX HEAD	MAX CAPACITY	WEIGHT
	kW	HP	SINGLE ϕ		THREE ϕ		m	lpm	kg
			μ f	230V	230V	400V			
EDX-70/03	0.25	0.3	10	2	1.4	0.8	12	110	7
EDX-70/05	0.37	0.5	20	4.2	2.5	1.4	20.7	130	9.4
EDX-70/07	0.55	0.75	20	5.2	3.5	2	28	142	10.6
EDX-90/10	0.75	1.0	30	6.2	4.2	2.4	29	155	11.2

MODEL	CAPACITY (Q)							
	l/min	20	40	60	80	100	120	140
	m ³ /h	1.2	2.4	3.6	4.8	6	7.2	8.4
EDX-70/03	H = Total Head	11.5	10.8	9.8	8.5	7	-	-
EDX-70/05		19.7	18.1	16.1	14	11.5	9	-
EDX-70/07		25.9	23.4	20.5	17.5	14.7	11.5	8.2
EDX-90/10		27.4	25.5	23.5	21.5	19.4	17.1	15.8

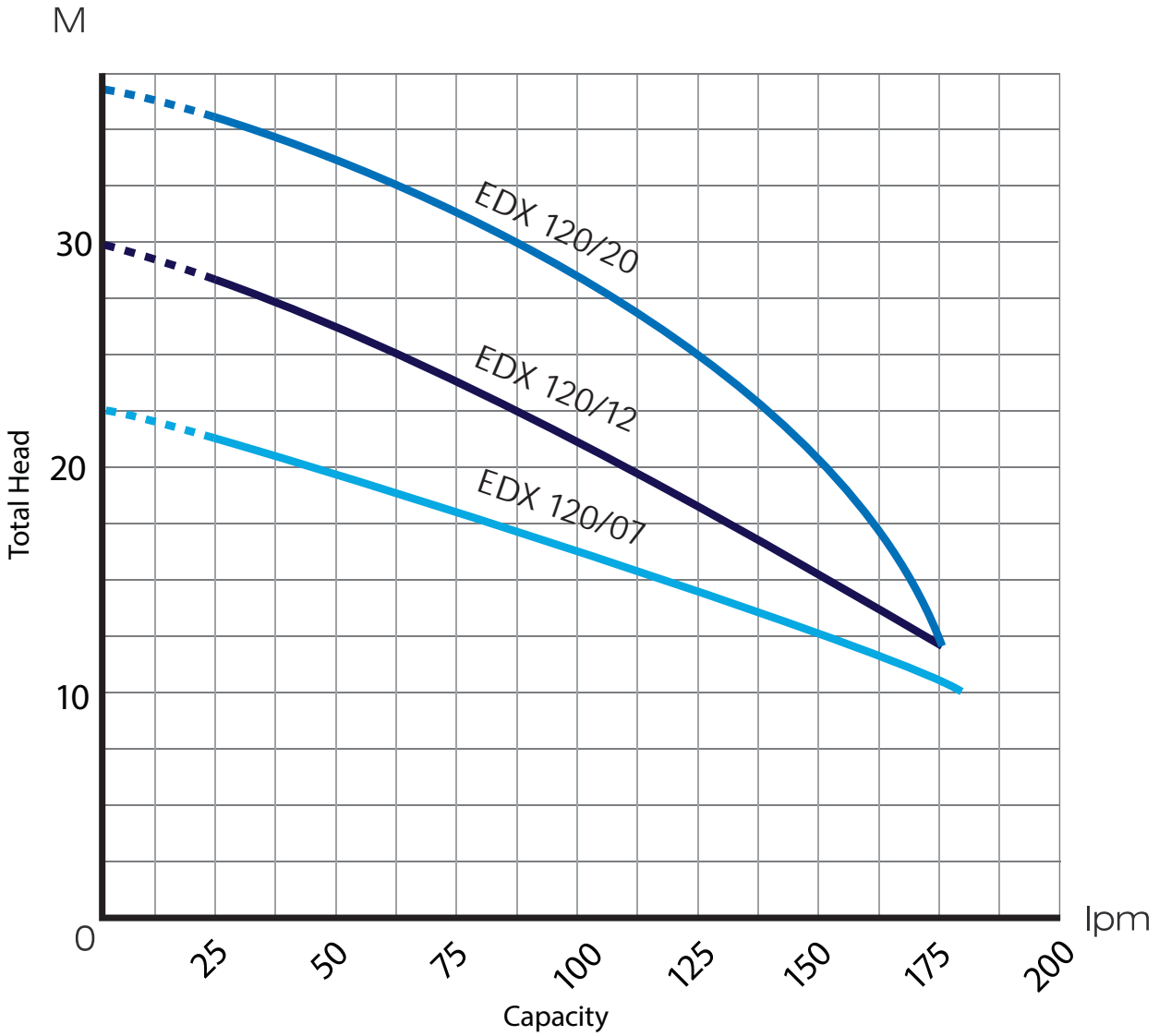

MODEL	POWER		CURRENT (A)				MAX HEAD	MAX CAPACITY	WEIGHT
	kW	HP	SINGLE ϕ		THREE ϕ		m	lpm	kg
			μ f	230V	230V	400V			
EDX-120/07	0.55	0.75	20	5.2	3.5	2	22.5	180	10.3
EDX-120/12	0.9	1.2	25	6.8	5.2	3	30	175	15.6
EDX-120/20	1.5	2.0	50	14	9	5.2	37	175	18.5

MODEL	CAPACITY (Q)							
	l/min	25	50	75	100	125	150	175
		m3/h	1.5	3.0	4.5	6	7.5	9
EDX-120/07	H =	21.3	19.7	18	16.3	14.5	12.5	10.6
EDX-120/12	Total Head	28.5	26.3	23.8	21.2	18.2	15.2	12
EDX-120/20	Head	35.5	33.7	31.3	28.5	25	20.3	12

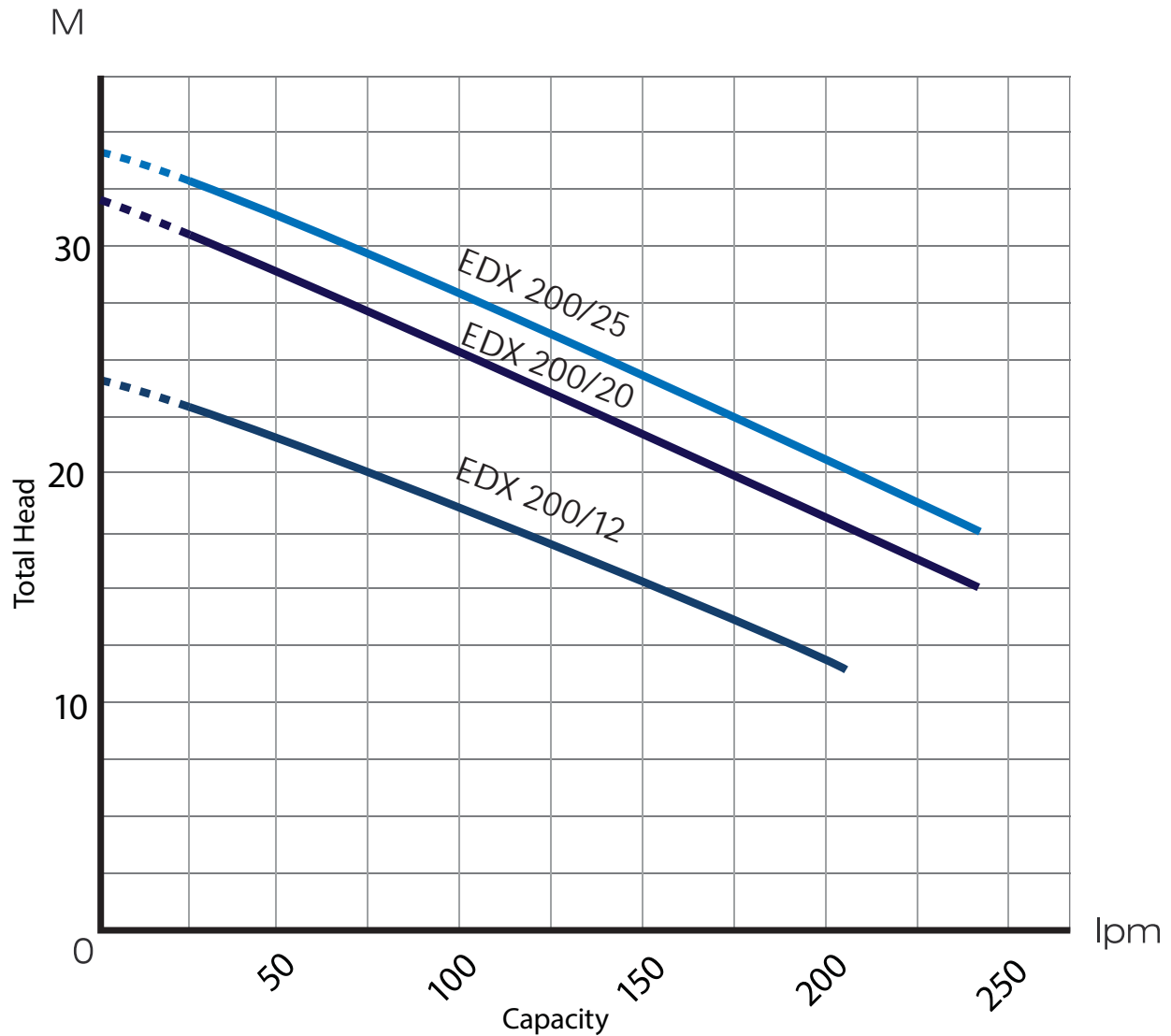

MODEL	POWER		CURRENT (A)				MAX HEAD	MAX CAPACITY	WEIGHT
	kW	HP	SINGLE ϕ		THREE ϕ		m	lpm	kg
			μ f	230V	230V	400V			
EDX-200/12	0.9	1.2	25	6.8	5.2	3	24	210	16
EDX-200/20	1.5	2.0	24	9.6	6.9	4	32	240	19.1
EDX-200/25	1.85	2.5	50	14	9.1	5.3	34	240	21.3

MODEL	CAPACITY (Q)									
	l/min	25	50	75	100	125	150	175	200	225
	m ³ /h	1.5	3.0	4.5	6	7.5	9	10.5	12	13.5
EDX-200/12	H =	23	21.5	20	18.6	17	15.3	13.6	12	-
EDX-200/20	Total	30.5	29.1	27.1	25.3	23.7	21.7	20	18.2	16.3
EDX-200/25	Head	32.8	31.5	29.6	28	26.3	24.5	22.5	20.7	18.7

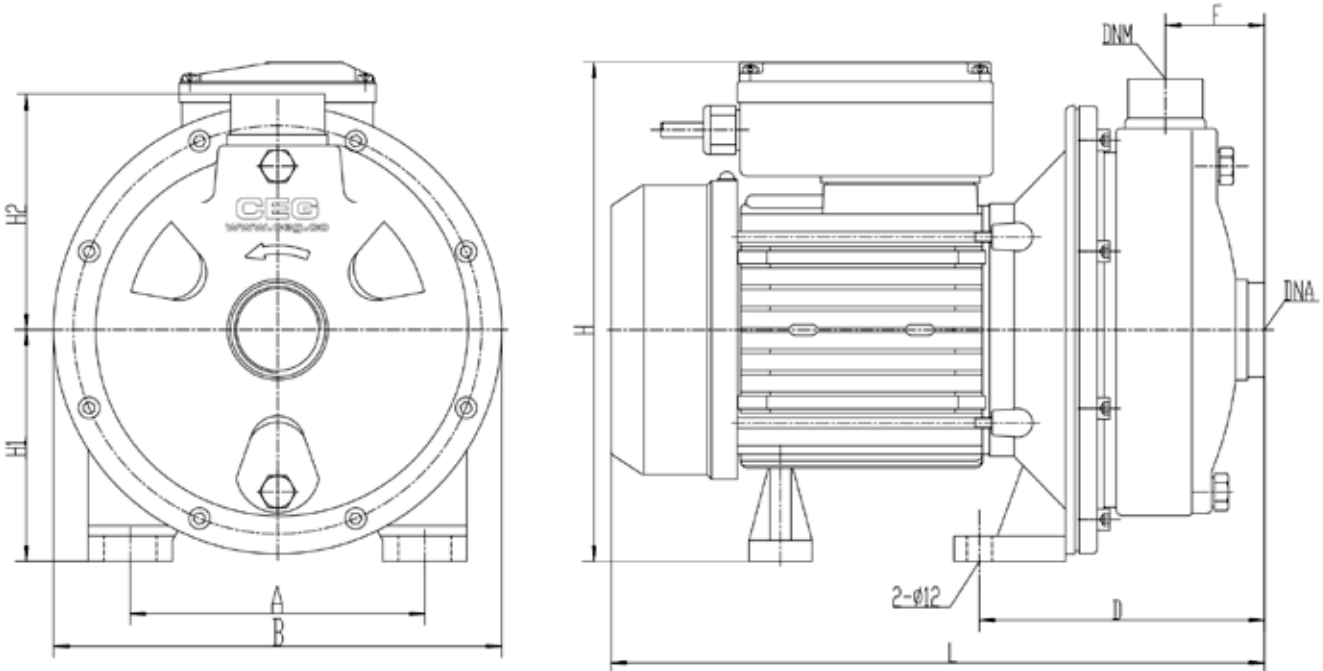

MODEL	DIMENSIONS (mm)									
	A	B	D	F	L	H	H1	H2	DNA	DNM
EDX-70/03	100	166	118	50	265	196	84	95	G 1¼	G 1
EDX-70/05	140	213	138	49	315	237	110	122	G 1¼	G 1
EDX-70/07	140	213	138	49	315	237	110	122	G 1¼	G 1
EDX-90/10	140	213	138	49	315	237	110	122	G 1¼	G 1
EDX-120/07	140	213	138	49	315	237	110	122	G 1¼	G 1
EDX-120/12	140	213	138	49	337	251	110	122	G 1¼	G 1
EDX-120/20	150	234	140	46	373	255	120	120	G 1¼	G 1
EDX-200/12	140	213	138	49	337	251	110	112	G 1½	G 1
EDX-200/20	140	213	138	49	366	255	110	112	G 1½	G 1
EDX-200/25	140	213	138	49	366	255	110	112	G 1½	G 1